

ON SEQUENCE

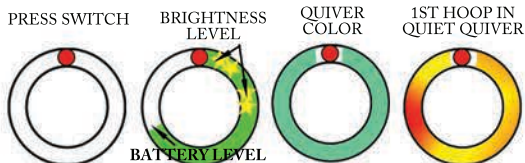

sequence will be the same in all orientations though quiver colors will be different

HALF-OFF SEQUENCE

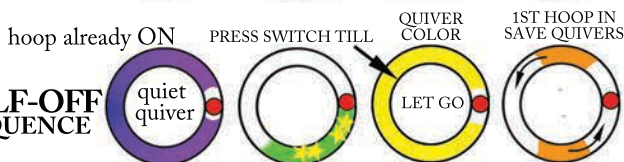

use to access more quivers by changing orientations without turning hoop off

OFF SEQUENCE

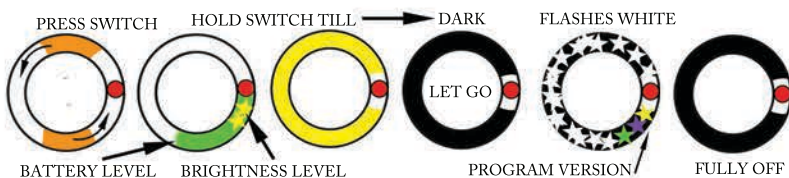

LEFT HAND ISOFLIP

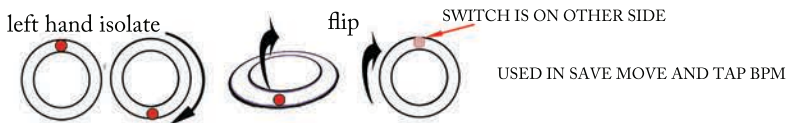

RIGHT HAND ISOFLIP

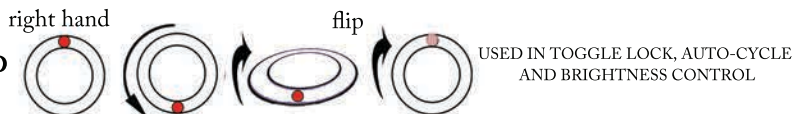

LEFT HAND ISOFLAP

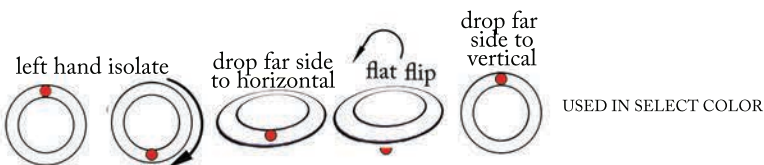

RIGHT HAND ISOFLAP

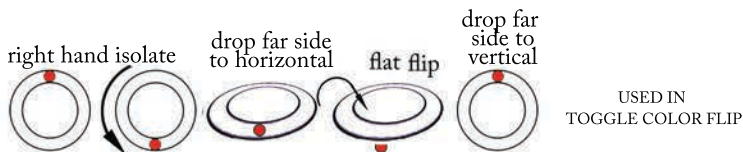

HALF-BACK

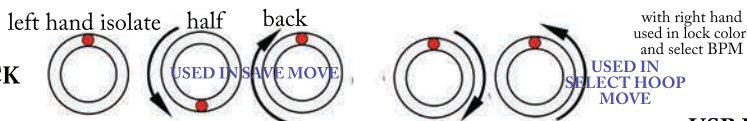

CONNECT DISCONNECT

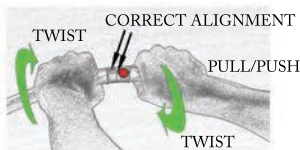

USB PORT

USB PORT

USB PORT

FRAGILE

TAKE extra CARE